

# L6580V2

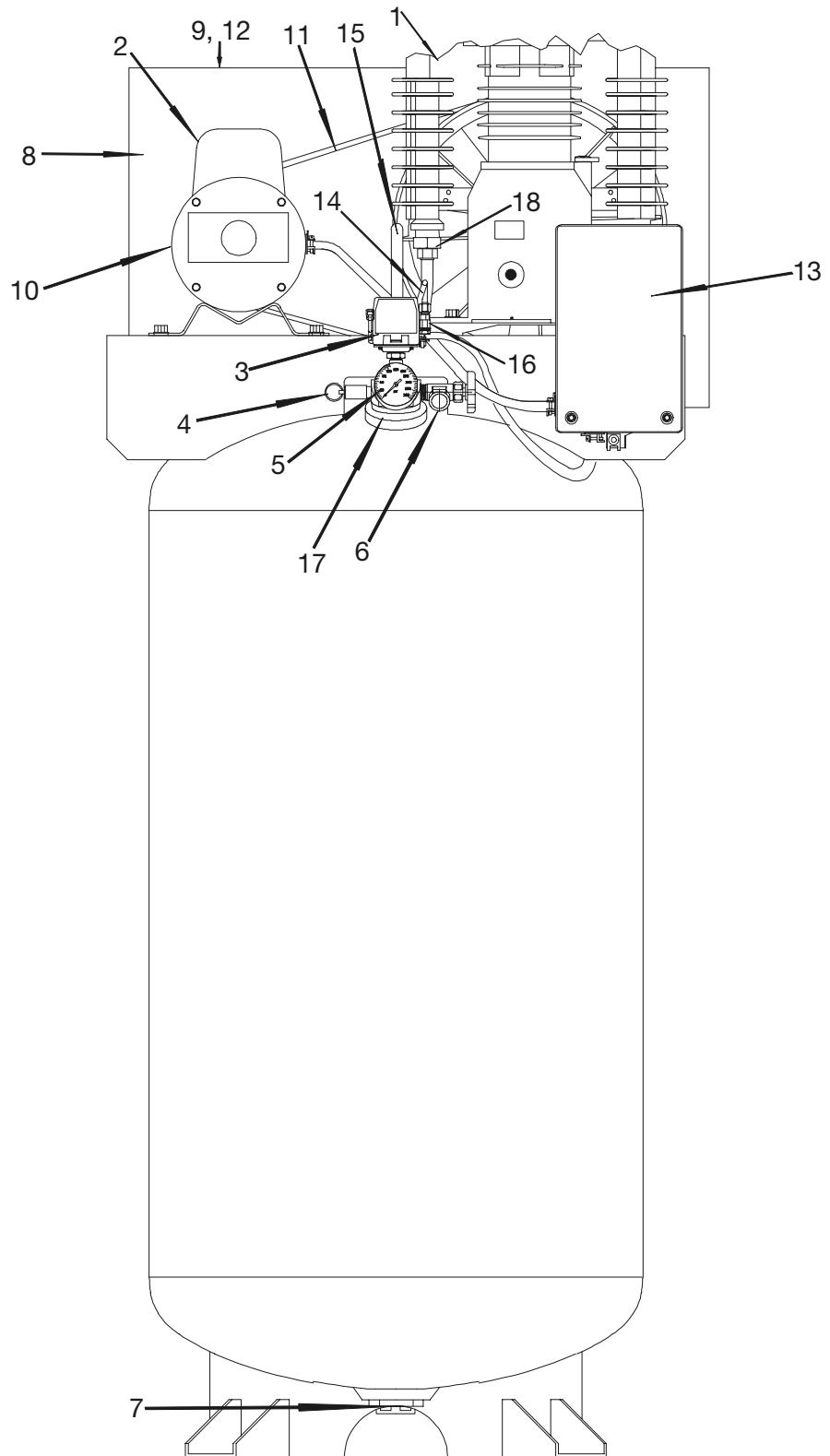

# L6580V2 (cont'd)

<b>Key No.</b>	<b>Part Number</b>	<b>Description</b>
1	• BAL-T39	PUMP ASSEMBLY
2	MO-9070	MOTOR
3	DAC-278-2	PRESSURE SWITCH
4	TIA-4200	SAFETY VALVE
5	GA-360	PRESSURE GAUGE
6	SSV-6	BALL VALVE
7	SS-2707	DRAIN VALVE
8	AC-0511	INSIDE BELTGUARD
	AC-0523	OUTSIDE BELTGUARD
9	SSF-953-ZN	BELT GUARD SCREW (2 used)
10	PU-2897	MOTOR PULLEY
11	BT-314	BELT (2 used)
12	SSF-8131	BELTGUARD NUT (2 used)
13	DAC-300-1	CONTACTOR BOX
14	DAC-304	PRESSURE RELIEF TUBE
15	AC-0517	OUTLET TUBE
16	SSP-7811	NUT/SLEEVE ASSEMBLY 1/4" (2 USED)
17	K-0609	MANIFOLD REPLACEMENT KIT
18	SSP-7824	NUT/SLEEVE ASSEMBLY 5/8" (2 USED)

## **PART NOT SHOWN**

DAC-252	CHECK VALVE
AC-0467	BASE BRACKET
AC-0485	BASE BRACKET
KK-4315	PRESSURE RELIEF VALVE KIT

•See *Pumps Tab*