

LN1080H23M-1

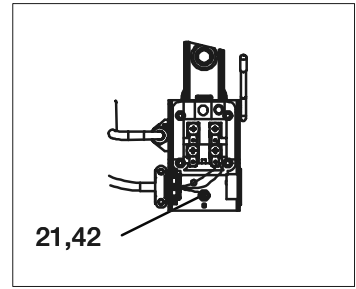

PRESSURE SWITCH WIRING

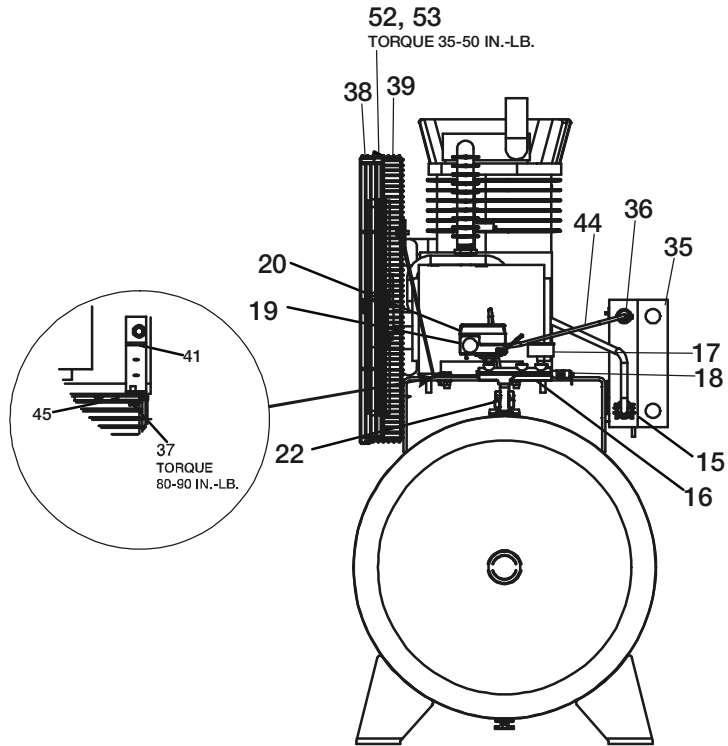
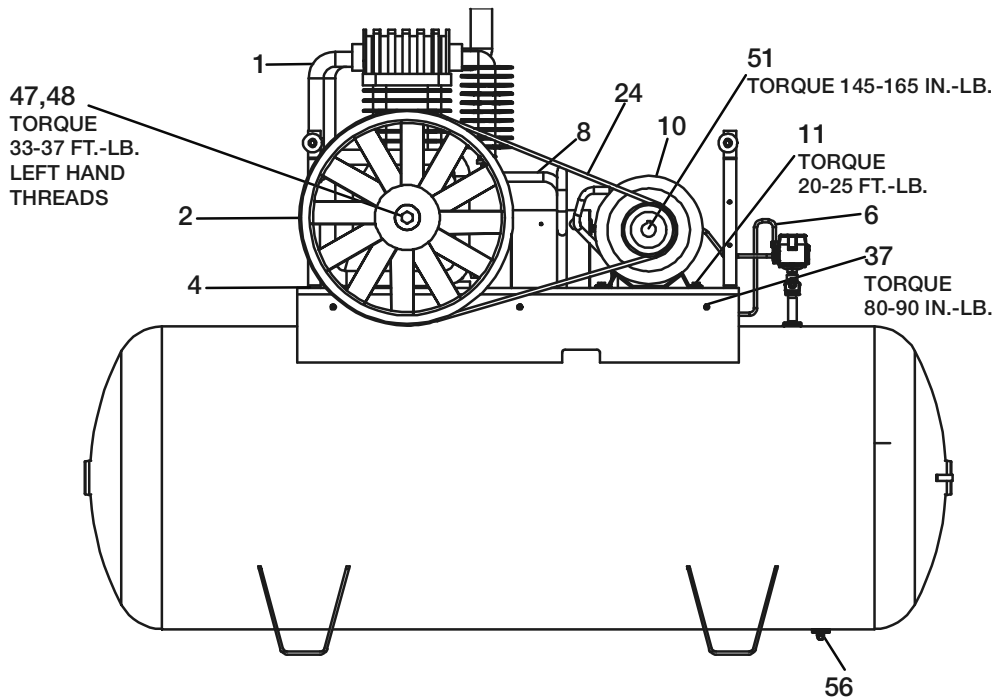
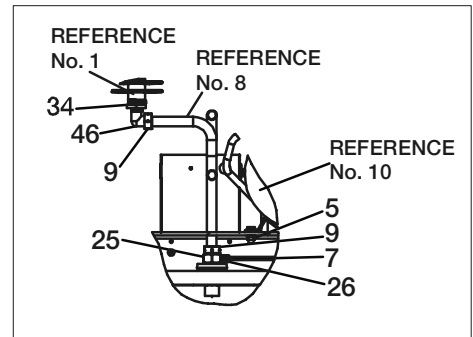

LN1080H23M-1 (cont'd)

KEY NO.	PART NUMBER	DESCRIPTION
* 1	BAL-T59S	PUMP ASSEMBLY
2	AC-0583	FLYWHEEL
4	SSF-3159	SCREW, 3/8-16 X 2 HEX WASHER HEAD
5	SSF-8111-ZN	LOCK NUT 3/8-16 WHIZ LOCK
6	AC-0459	PRESSURE RELIEF TUBE
7	SSP-7811	NUT SLEEVE ASSEMBLY 1/4"
8	AC-0683	OUTLET TUBE 3/4 OD
9	SSP-7815	NUT SLEEVE ASSEMBLY
10	MO-9082	MOTOR
11	SSF-3140-ZN	SCREW, 3/8-16 X 1 HEX FLANGE
15	SSW-8239	CONNECTOR BOX 3/4
16	CAC-95	MANIFOLD
17	GA-360-B	GAUGE
18	TIA-4200	SAFETY VALVE
19	DAC-278-2	PRESSURE SWITCH
20	AC-0615	PRESSURE SWITCH COVER
21	SUDL-9-1	SCREW, 8-32 X.375//344
22	SS-2110	NIPPLE 3/8X3
24	BT-316	BELT "V" 74.3
25	AC-0465	CHECK VALVE
26	SS-8553	CONNECTOR BODY
34	AC-0734	BUSHING, REDUCER, 1 1/4 NPT X 1/2 NPT
35	AC-0478	CONTACTOR BOX
36	SSW-7482	CONNECTOR CONDUIT 3/8
37	91895680	SCREW, 1/4-20 X .75
38	AC-0460-1	INSIDE BELT GUARD
39	AC-0461	OUTSIDE BELT GUARD
41	AC-0485	BELT GUARD BRACKET
42	SSN-613	WASHER
44	AC-0525	CORD, PRESSURE SWITCH TO CONTACT BOX
45	SSN-1014-ZN	WASHER, .339/.344 ID 1 1/2 OD
46	SSP-530	ELBOW (MALE FITTING)
47	BAL-9110022	FLYWHEEL BOLT
48	BAL-9004009	FLYWHEEL WASHER
51	PU-2906	PULLEY, 4.75 OD 1.375 SHAFT
52	SSF-8131	SPEED NUT
53	SSF-953-ZN	SCREW, SELF TAPPING
56	SS-2707	DRAIN VALVE, 1/4"
	NOT SHOWN	
	SSV-6-B	OUTLET VALVE

***See the Pumps Tab.**